

SINGLE COLUMN GOODS LIFT

TECHNICAL SPECIFICATION



UP3 & UP25 MODELS TECHNICAL SPECIFICATION

The UP is a Single-column hydraulic lifting system certified for the transport of goods and/or one attendant on board with capacities from 300Kgs up to 2500Kgs. UP for goods-only model Optimize the loading surface for the material only and is suitable for connecting multiple levels. Suitable for being integrated in automated industrial plants. UP SPB with operator on board (attended) Allows the attendant to operate the system on board in complete safety. Moreover, improves usability and work capacity by reducing material loading/unloading timings.

SPECIFICATION TABLE

	Capacity	Max Travel Distance	Depth	Width	Pit	Minimum Headroom	Max. No. Stops	Power	Standard Motor (KW)
UP3	300 kg	7,000mm	1,300mm	1,700mm	120mm	2,150mm	5	Single phase	1,5
UP25	2,500 kg	16,000mm	1700mm / 1900mm	2,500mm / 1,900mm	250mm	2,150mm	5	Three phase	5,5



For enquiries please contact us at info@hlsequipment.com

UP3 MODEL - GOODS ONLY

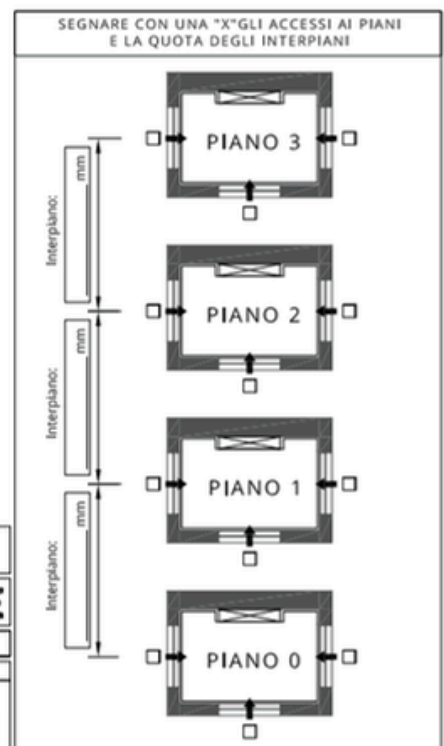
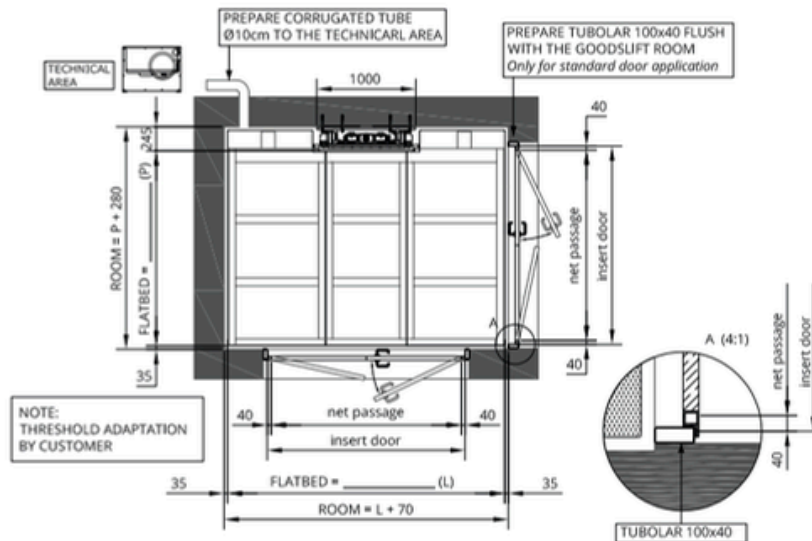
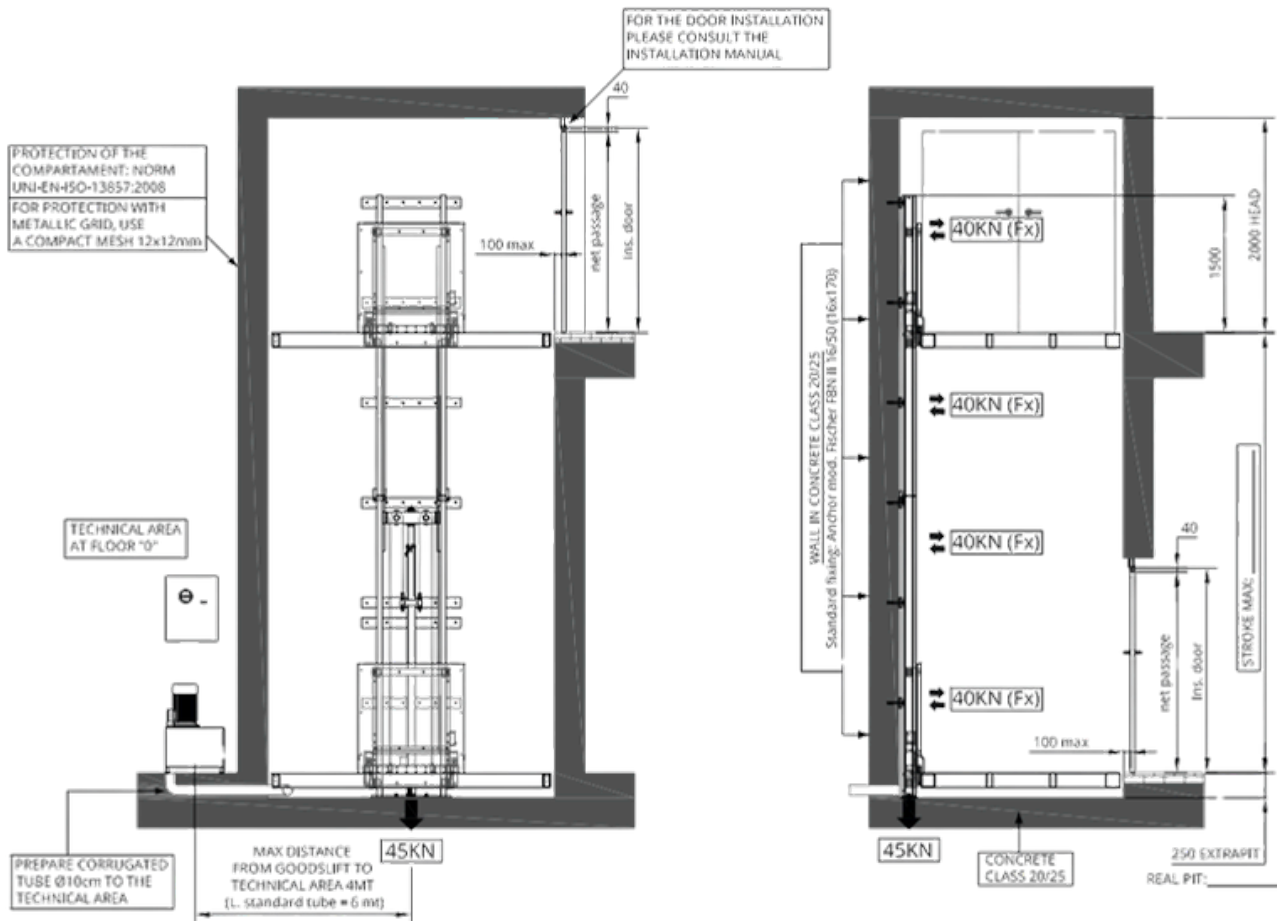

PREPARE POWER F-40/45 or 3F-1/16 SMITH AUTOMATIC MAGNETOTHERMIC WITH DIFFERENTIAL CURVE "CC", 40 = 0.3A

Motore	Funzionamento	Anzianità	Interruttore consigliata*	Corrente nominale	Corrente avviamento
5.5kW	220 V - trifase	Devoto	3x16A 40-0.3A	22	60
	380 V - trifase	Devoto	4x16A 40-0.3A	11	35
7.5kW	220 V - trifase	Devoto	3x20A 40-0.3A	30	90
	380 V - trifase	Devoto	4x16A 40-0.3A	14.5	45
9.2kW	220 V - trifase	Devoto	4x20A 40-0.3A	36	110
	380 V - trifase	Devoto	4x16A 40-0.3A	18	56

MODEL: ☐ UP20 - 2000Kg ☐ UP25 - 2500Kg

Date: _____ Signature for approval: _____



MISURE IN mm

Force on the wall, Fx function of depth flatbed

FLATBED DIMENSION (grey area)

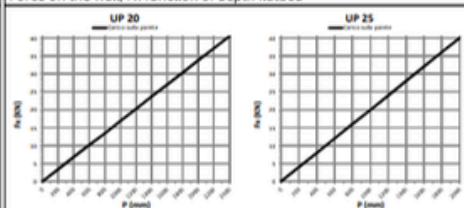
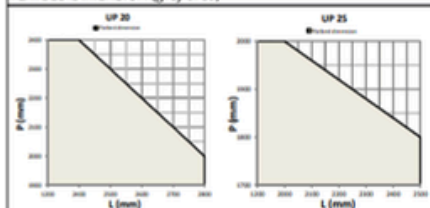

UP DYNAMIC Via Mongiard, 22 - 37045 Legnago (VR) - Tel 0442 510129 - Fax 0442 513631
www.updynamic.com - e-mail info@updynamic.com

DESCRIZIONE: MODEL: UP20 - 2000Kg UP25 - 2500Kg STROKE MAX: 12000mm ONLY FOR GOODS

Model: TAV-UP2025-STD01

Rev: 07/11/14

For enquiries please contact us at info@hlsequipment.com

UP3 - SPB MODEL - WITH ATTENDANT

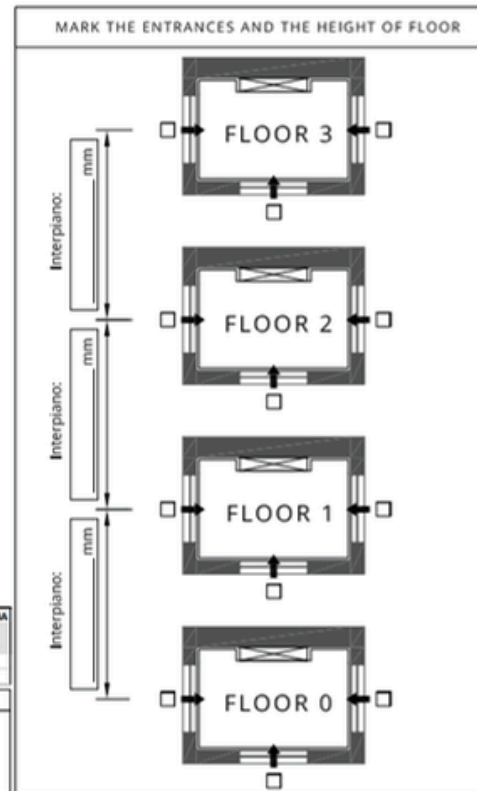
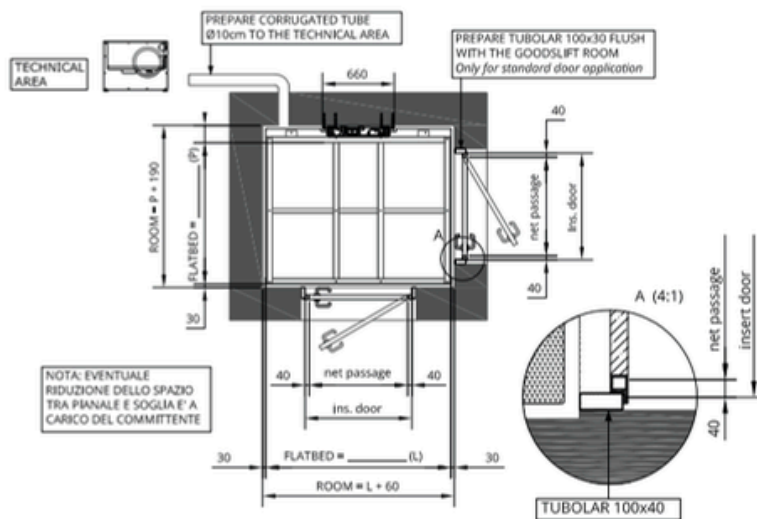
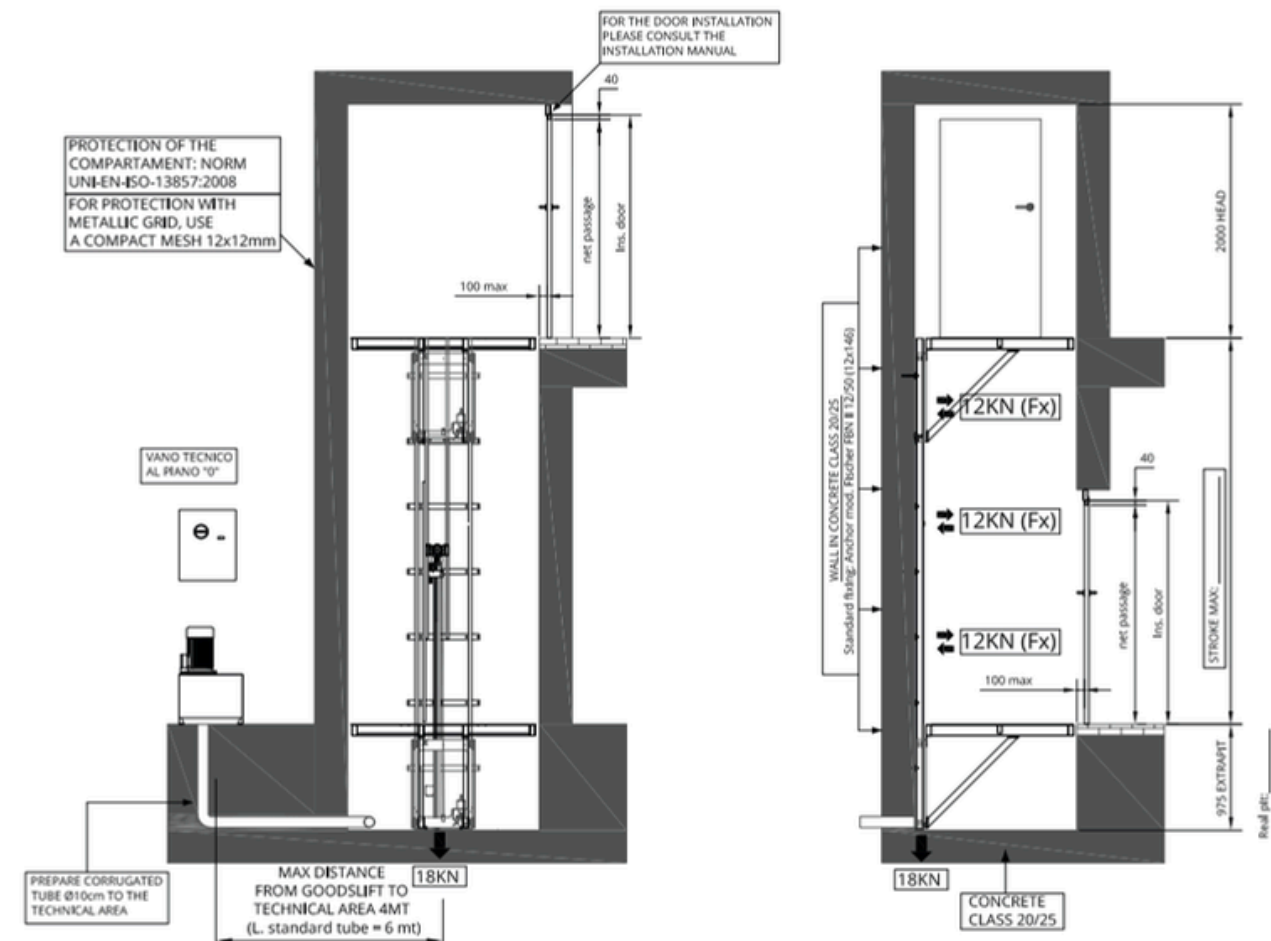

MODEL: ☐ UP3 - 300Kg ☐ UP6 - 600Kg

Date: _____

Signature for approval: _____

MISURE IN mm

CE

STROKE AND FLATBED DIMENSION			
MODEL	WIDTH (mm)	DEPTH (mm)	STROKE MAX (mm)
UP 3	1700	1300	7000
UP 6	1700	1300	7000

PREPARE POWER PH-T-N SWITCH AUTOMATIC MAGNETOTHERMIC WITH DIFFERENTIAL CURVE "C", Id = 0.3A

Motore	Tensione funzionamento	Avviamento	Interruttore consigliato*	Corrente nominale	Corrente avviamento
1,5kW	220 V - monofase	Diretto	2x16A Id=0,3A	9,5	28
2,2kW	220 V - monofase	Diretto	2x16A Id=0,3A	10,5	32

Force on the wall, Fx function of depth flatbed

UP 3

Curva sulla parete

UP 6

Curva sulla parete

UP DYNAMIC

Via Modigliani, 22 - 37045 Legnago (VR) - Tel. 0442.59.01.29 - Fax. 0442.59.90.91
www.updynamic.com - e-mail: info@updynamic.com

Q.T.A.

DESCRIZIONE:

MODEL: UP3R - 300Kg
UP6R - 600Kg
STROKE MAX: 7000mm
ONLY FOR GOODS

Client: _____
Data: 07/11/14

Signat.: _____
Firma: _____

TAV-UP36R-STD01

For enquiries please contact us at info@hlsequipment.com

UP3 - UPR - WITH REVERSE TROLLEY - GOODS ONLY

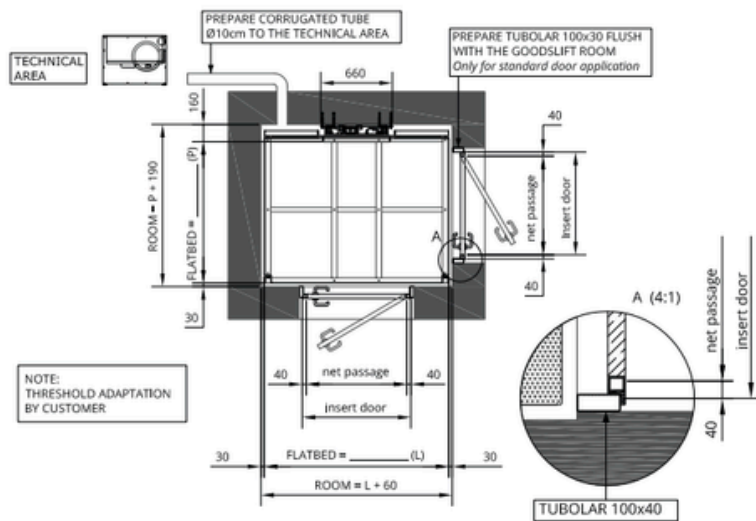
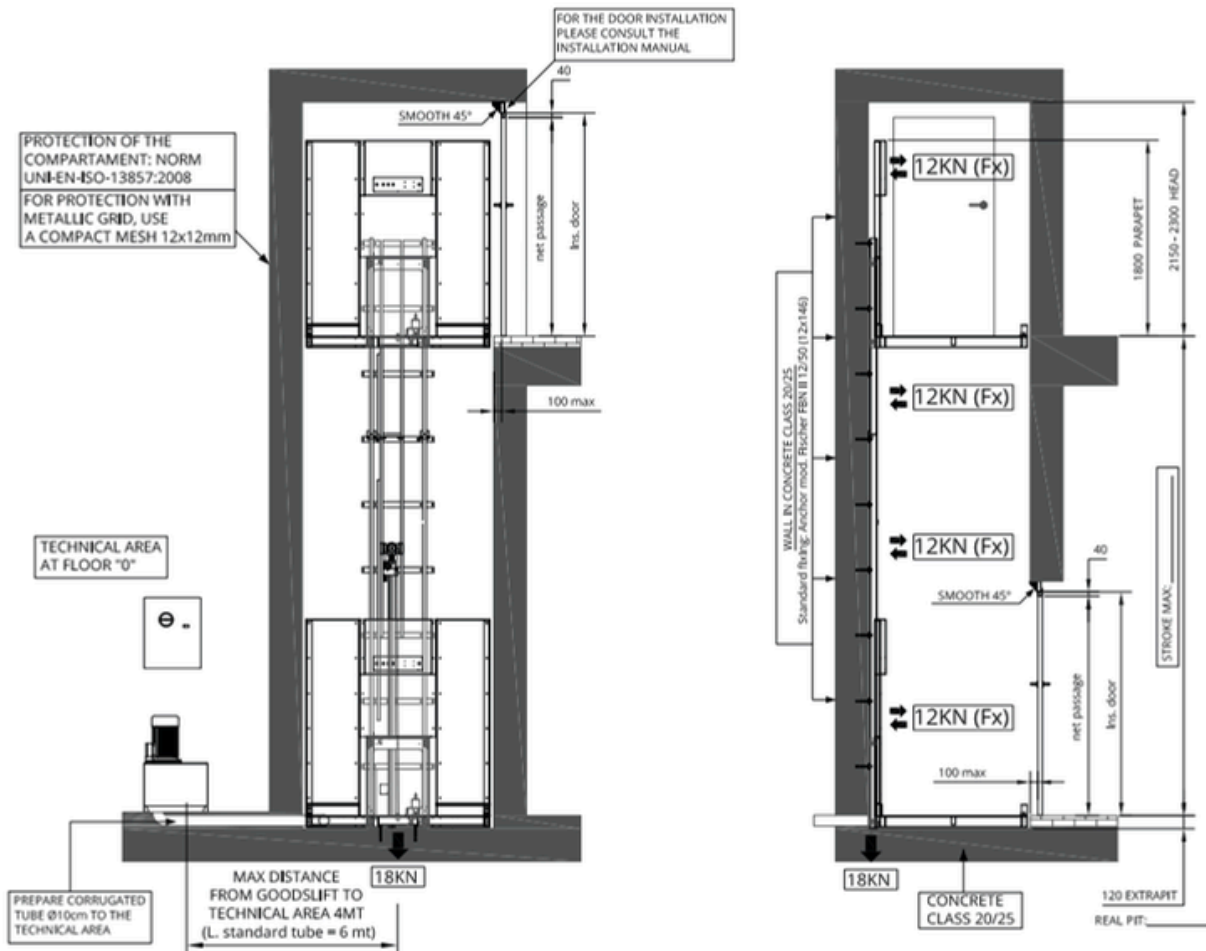

MARK THE ENTRANCES AND THE HEIGHT OF FLOOR

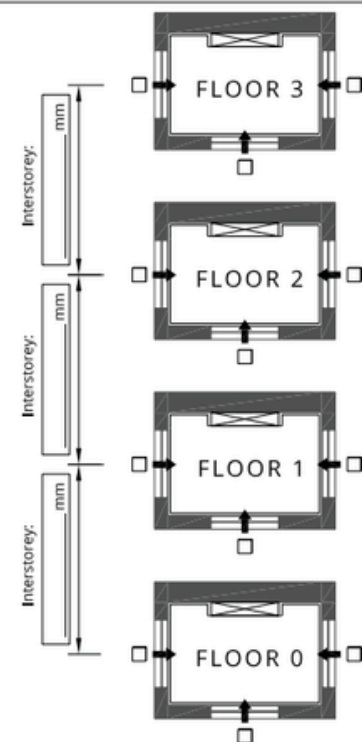

MODEL: ☐ UP3 - 300Kg ☐ UP6 - 600Kg

Date: _____

Signature for approval: _____



MISURE IN mm

STROKE AND FLATBED DIMENSION

MODEL	WIDTH (mm)	DEPTH (mm)	STROKE MAX (mm)
UP 3	1700	1300	7000
UP 6	1700	1300	7000

PREPARE POWER PH-T-N SWITCH AUTOMATIC MAGNETOTHERMIC WITH DIFFERENTIAL CURVE "C", Id = 0.3A	Tensione funzionamento	Avvolgimento	Interruttore consigliato*	Corrente nominale	Corrente avviamento
1,5kW	220 V - monofase	Diretto	2x16A Id=0,3A	9,5	28
2,5kW	220 V - monofase	Diretto	2x16A Id=0,3A	10,5	32

Force on the wall, Fx function of depth flatbed

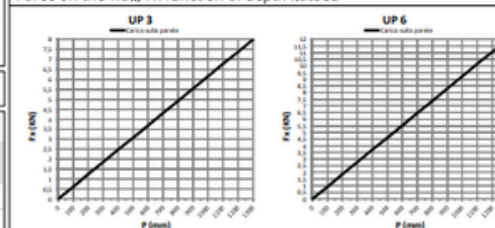

UP DYNAMIC Via Modigliani, 22 - 37045 Legnago (VR) - Tel. 0442.59.01.29 - Fax. 0442.59.90.91
www.updynamic.com - e-mail: info@updynamic.com

DESCRIZIONE:

MODEL: UP3 - 300Kg
UP6 - 600Kg
STROKE MAX: 7000mm
WITH OPERATOR ON BOARD

Client: _____
Model: _____
Date: 07/11/14
Project: _____
TAV-UP36-SPB01
Technical: _____

For enquiries please contact us at info@hlsequipment.com

UP3 - UPRSPB - WITH REVERSE TROLLEY - WITH ATTENDANT

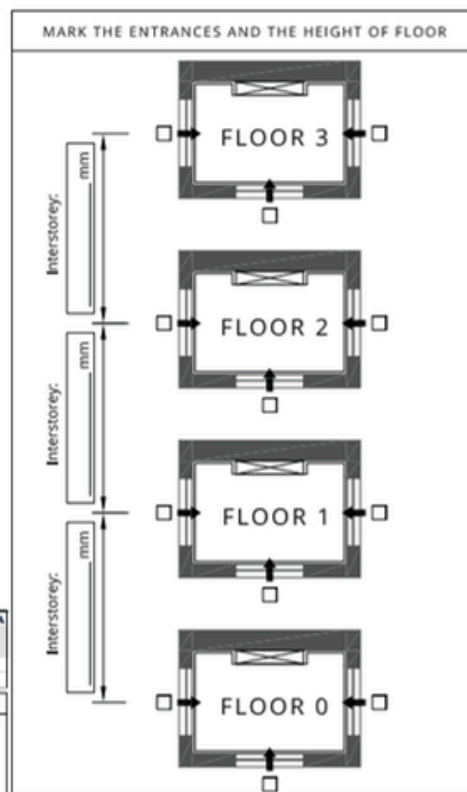
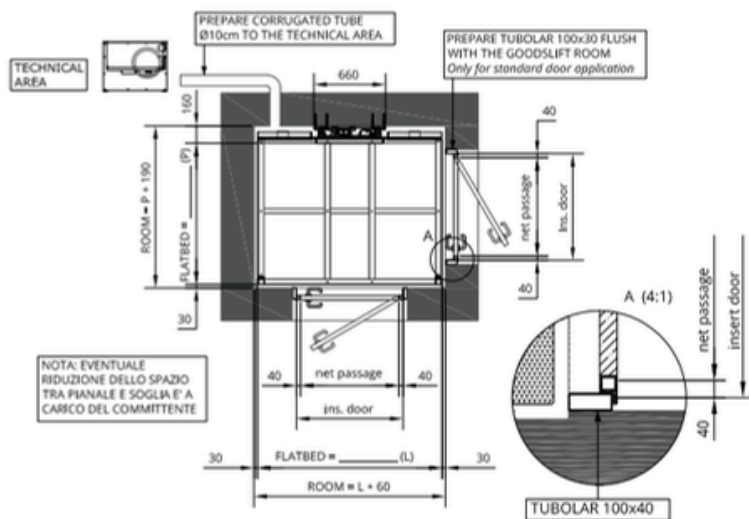
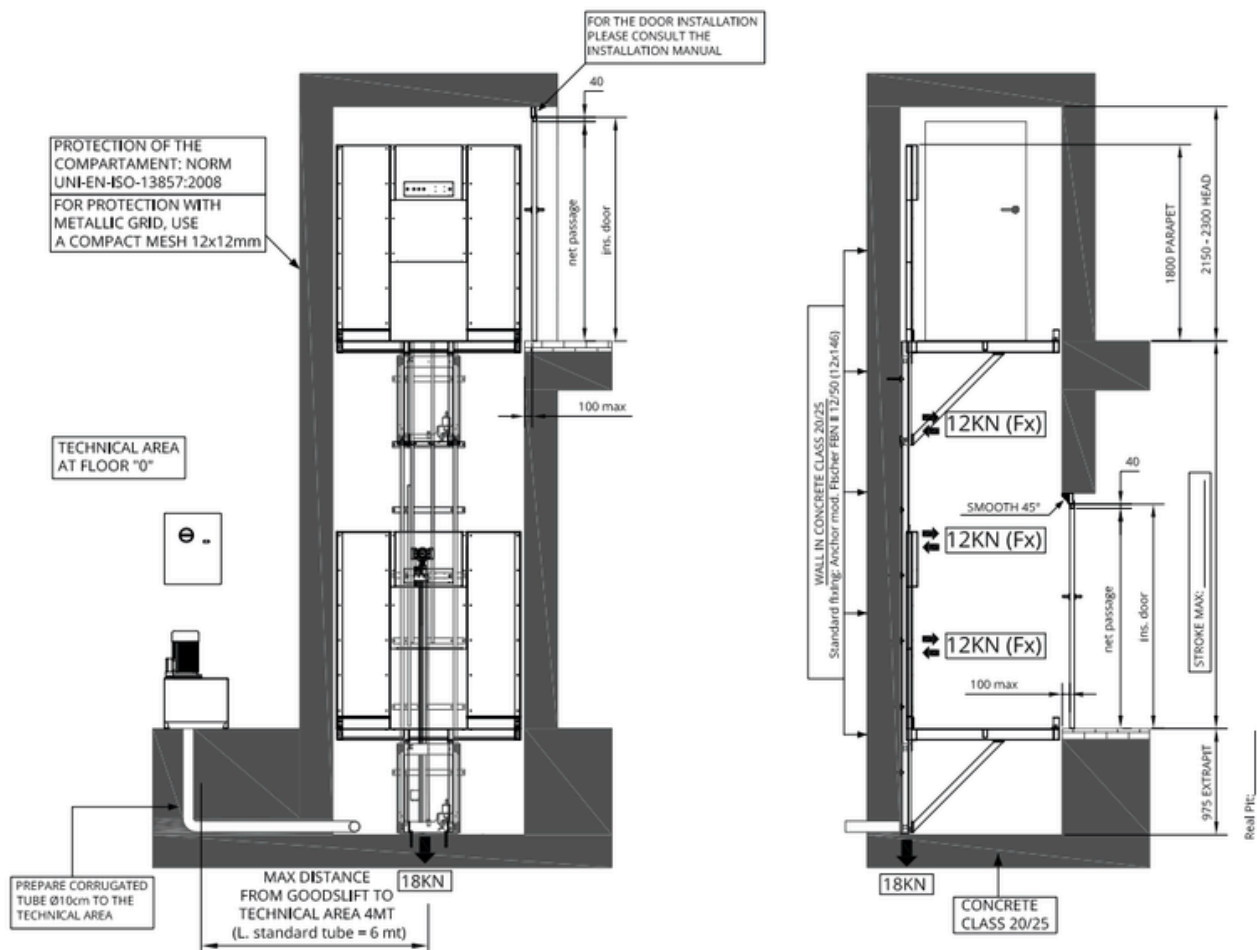

MODEL: ☐ UP3 - 300Kg ☐ UP6 - 600Kg

Date: _____

Signature for approval _____

MISURE IN mm

MODEL	WIDTH (mm)	DEPTH (mm)	STROKE MAX (mm)
UP 3	1700	1300	7000
UP 6	1700	1300	7000

Motore	Tensione funzionamento	Avviamento	Interruttore consigliato*	Corrente nominale	Corrente avviamento
1,5kW	220 V - monofase	Diretto	2x16A id=0,3A	9,5	28
2,2kW	220 V - monofase	Diretto	2x16A id=0,3A	10,5	32

Force on the wall, F_x function of depth flatbed

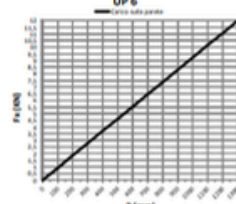
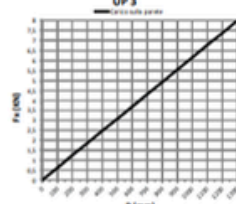

UP DYNAMIC Via Modigliani, 22 • 37045 Legnago (VR) • Tel. 0442.59.01.29 • Fax. 0442.59.90.91
www.updynamic.com • e-mail: info@updynamic.com

Q.TA	DESCRIZIONE:	Cliente :
------	--------------	-----------

	MODEL: UP3R - 300Kg UP6R - 600Kg STROKE MAX: 7000mm WITH OPERATOR ON BOARD	Date: 07/11/1 Model: TAV-UP36R-SPB01
	Serial:	Serial:

UP25 MODEL - GOODS ONLY

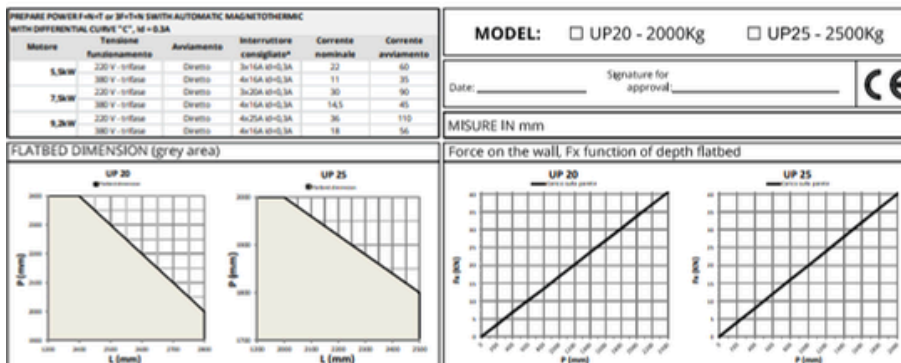
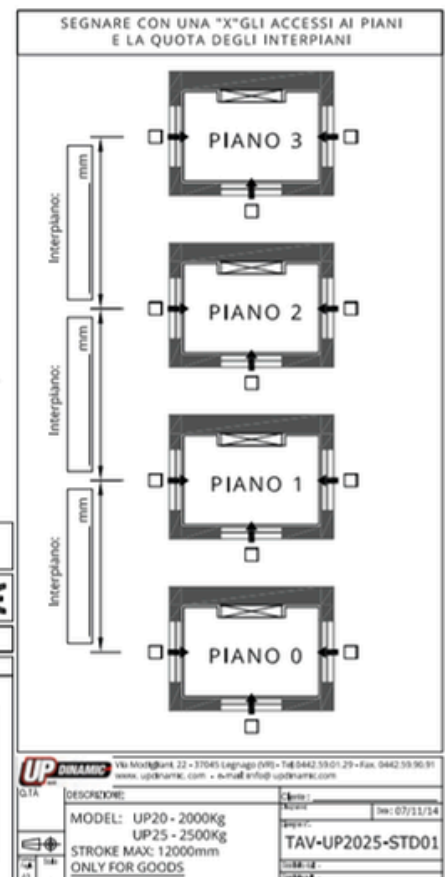
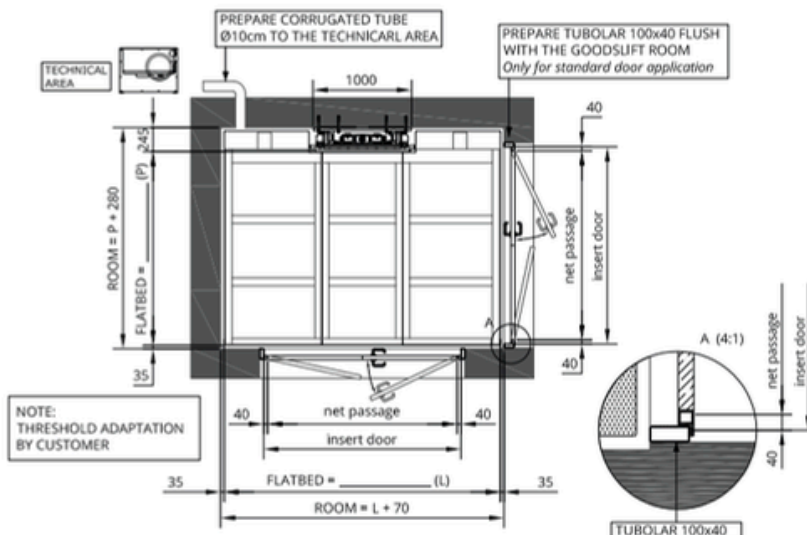
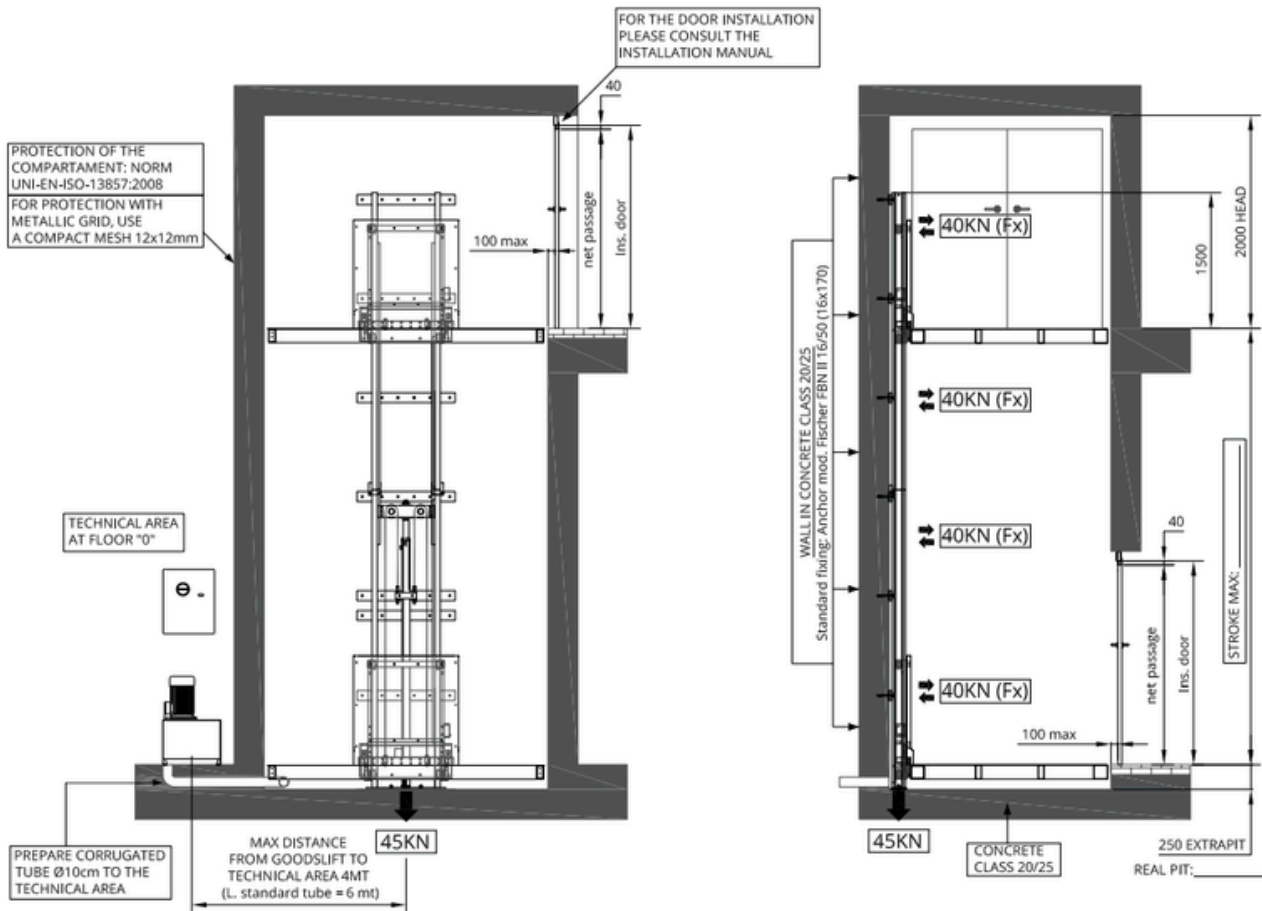

For enquiries please contact us at info@hlsequipment.com

UP25 - SPB MODEL - WITH ATTENDANT

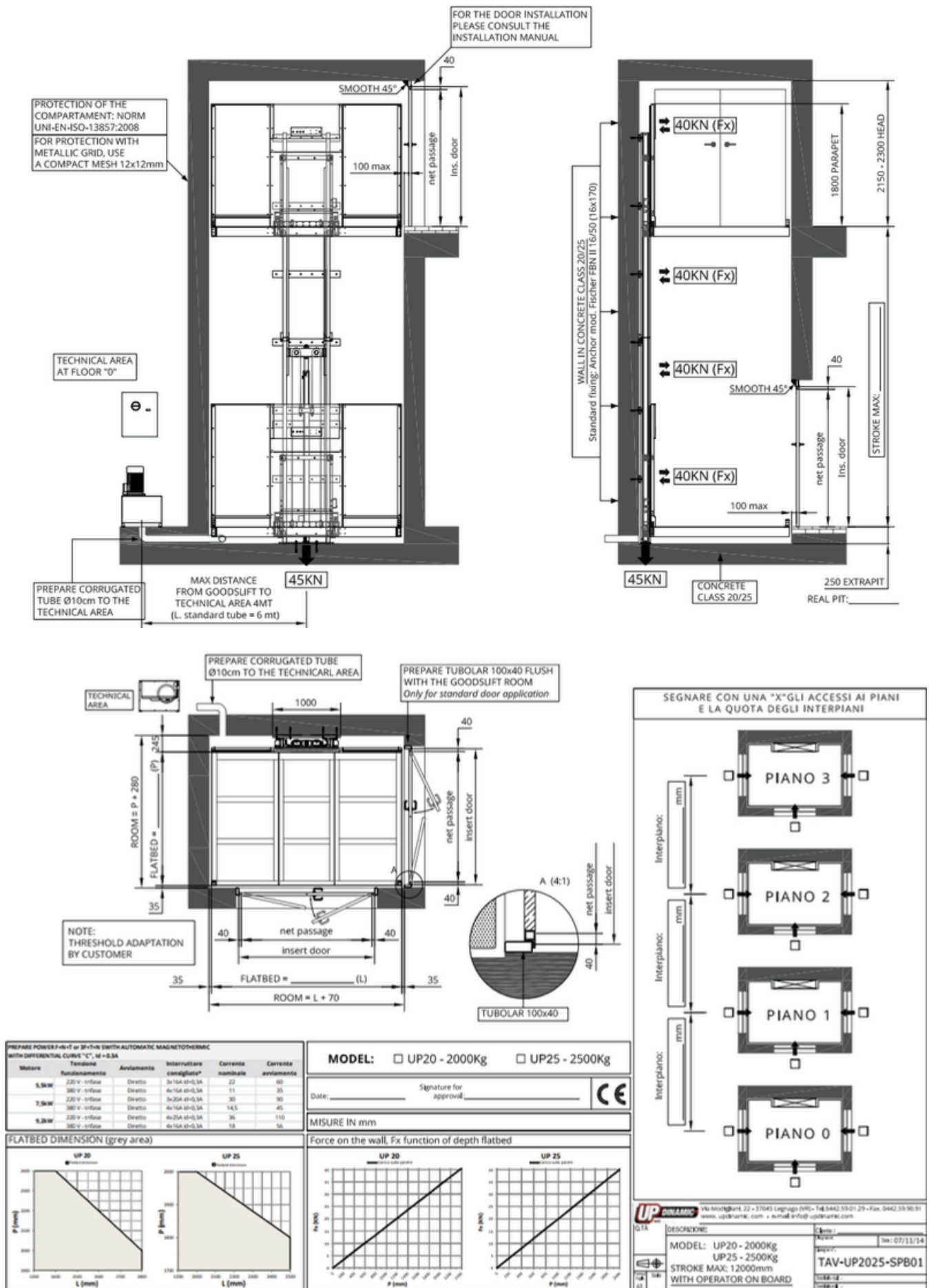

For enquiries please contact us at info@hlsequipment.com

UP25 - UPR - WITH REVERSE TROLLEY - GOODS ONLY

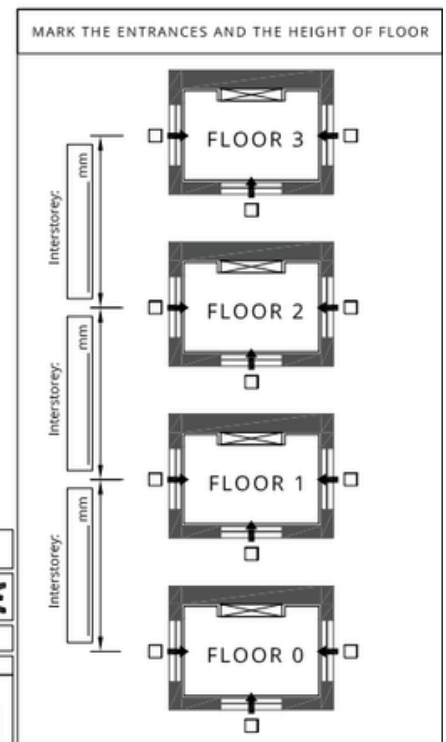
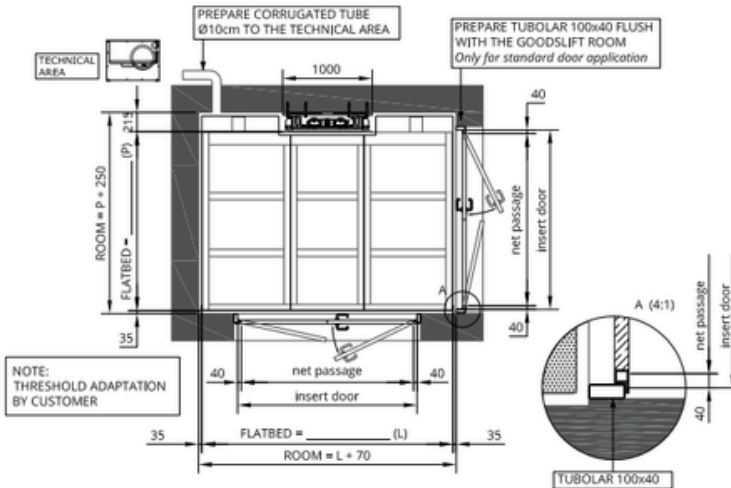
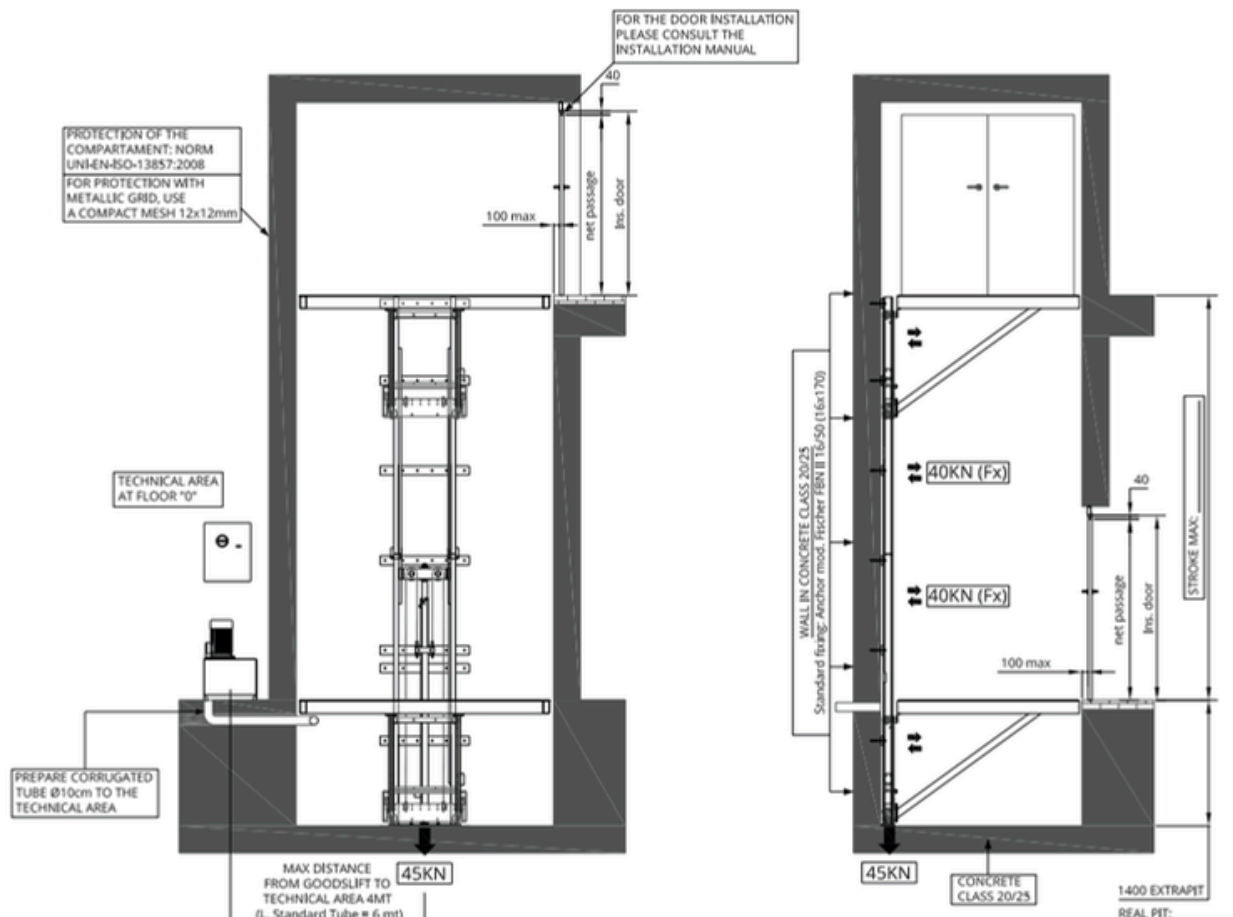

PREPARE POWER 3P+1+N WITH AUTOMATIC MAGNETOTHERMIC WITH DIFFERENTIAL CURVE "C", 30 + 0.3A

Motor	Tensione funzionamento	Avvolgimento	Interruttore consigliata*	Corrente nominale	Corrente avviamento
3kW	220 V - trifase	Diretto	3x16A Id=0.3A	10	35
	380 V - trifase	Diretto	4x16A Id=0.3A	5	22
	220 V - trifase	Diretto	3x25A Id=0.3A	16	50
4kW	380 V - trifase	Diretto	4x16A Id=0.3A	8	25
	220 V - trifase	Diretto	4x25A Id=0.3A	22	60
	380 V - trifase	Diretto	4x16A Id=0.3A	11	35

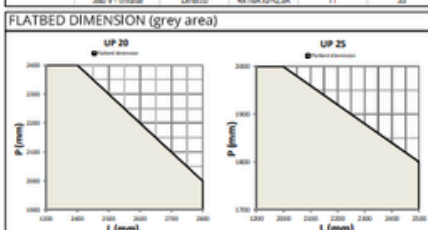

MODEL: ☐ UP20 - 2000Kg ☐ UP25 - 2500Kg

Date: _____ Signature for approval: _____

MISURE IN mm

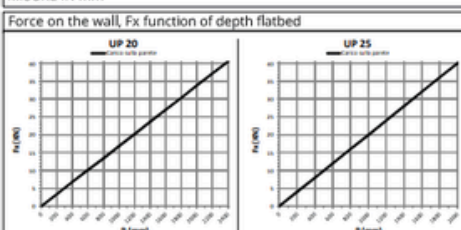

UP DYNAMIC

Via Modugno 22 - 37045 Legnago (VR) - Tel 0442 59 01 29 - Fax 0442 59 90 91
www.updynamic.com - e-mail info@updynamic.com

Q.1A

DESCRIZIONE: MODEL: UP20 - 2000Kg UP25 - 2500Kg STROKE MAX: 12000mm ONLY FOR GOODS

Disegnato: _____ Data: _____

Verificato: _____ Data: 07/11/14

TAV-UP2025R-STD01

Tracciato: _____

For enquiries please contact us at info@hlsequipment.com

UP25 - UPRSPB - WITH REVERSE TROLLEY - WITH ATTENDANT

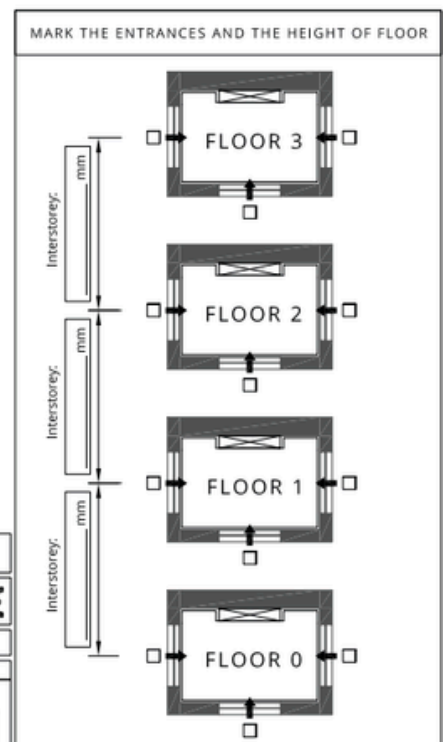
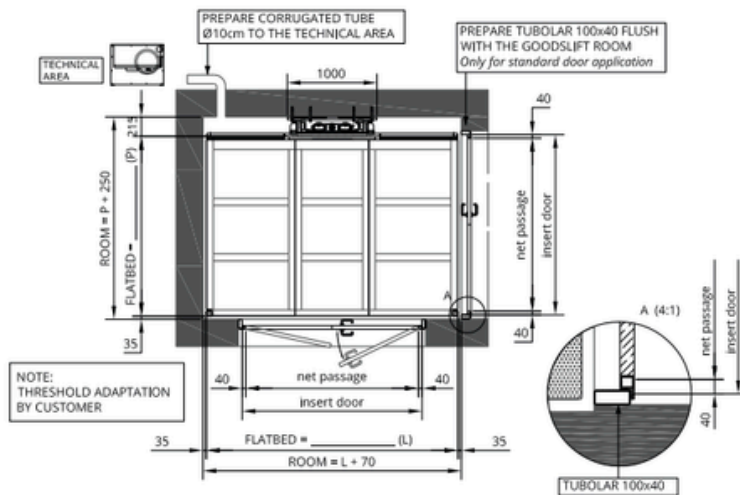
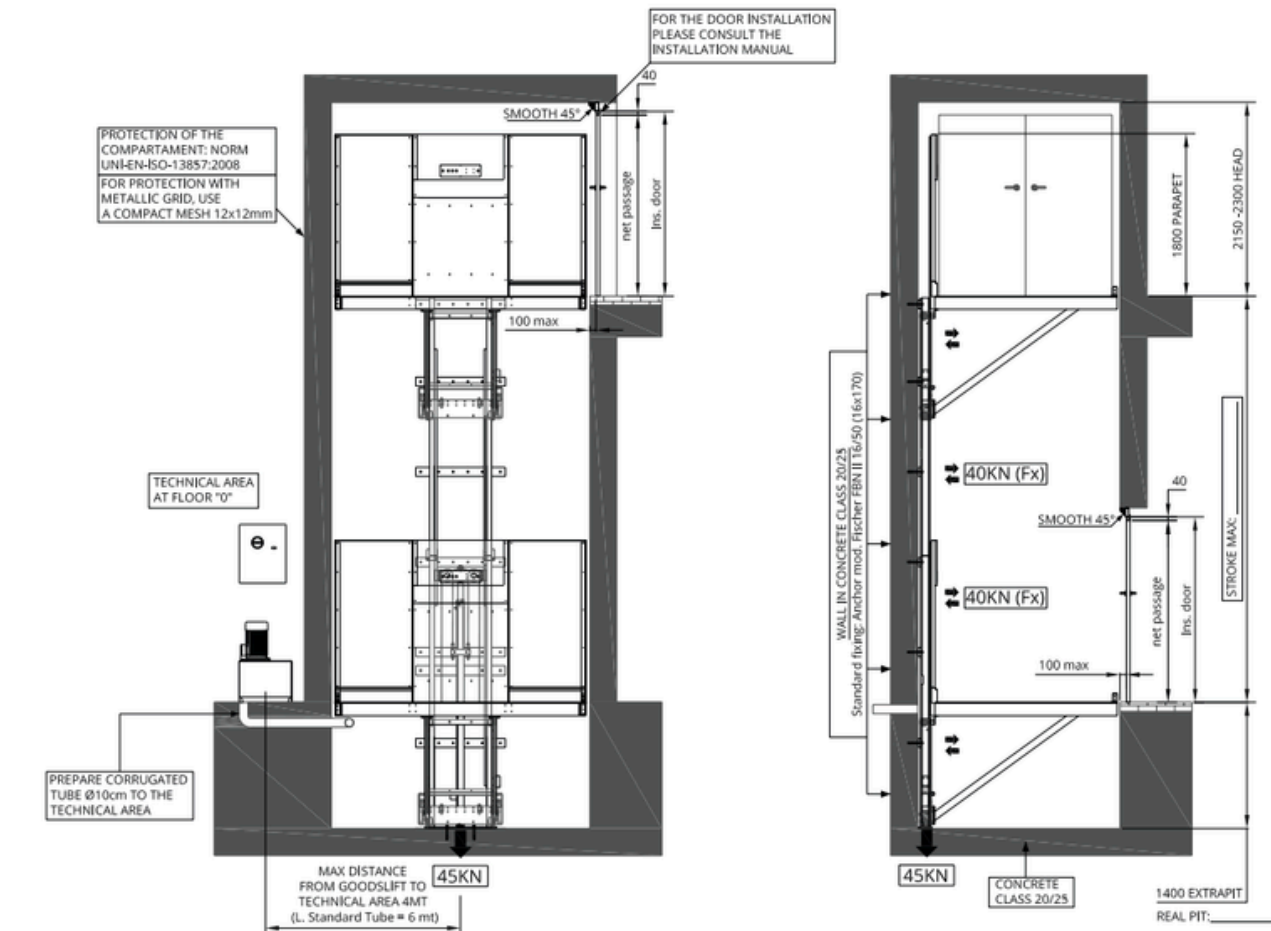

Modello	Tensione funzionamento	Avvolgimento	Interruttore consigliato*	Corrente nominale	Corrente avviamento
3kW	220 V - trifase	Diretto	3x16A id-Q.3A	10	35
	380 V - trifase	Diretto	4x16A id-Q.3A	5	22
4kW	220 V - trifase	Diretto	3x20A id-Q.3A	16	50
	380 V - trifase	Diretto	4x16A id-Q.3A	8	25
5.5kW	220 V - trifase	Diretto	4x25A id-Q.3A	22	60
	380 V - trifase	Diretto	4x16A id-Q.3A	11	35

MODEL: ☐ UP20 - 2000Kg ☐ UP25 - 2500Kg

Date: _____ Signature for approval: _____

MISURE IN mm

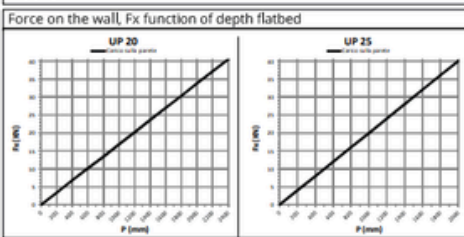
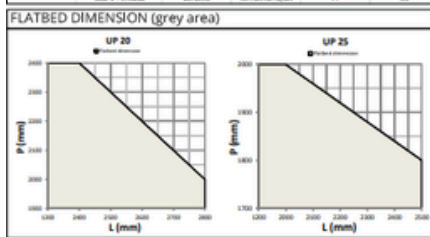

UP DYNAMIC

Modello: UP20 - 2000Kg
UP25 - 2500Kg
STROKE MAX: 12000mm
WITH OPERATOR ON BOARD

Disegnato: _____
Verificato: _____
Data: 07/11/14

TAV-UP2025R-SPB01

For enquiries please contact us at info@hlsequipment.com

SINGLE COLUMN GOODS LIFT (UP3 & UP25 MODELS)



Engineered & Manufactured in Europe



Designed for Australian site conditions

Please note: Dimensions and drawings within this technical specification are to be used as a guide only. Consultation with HLS Equipment is required for all projects.

Product of **UP** **DINAMIC**

For enquiries please contact us at info@hlsequipment.com